

KR o b 2 0 1 6

THE 42ND ANNUAL KEN ROBERTS MEMORIAL DELINEATION COMPETITION

Presented by h Dallas
Dallas Museum of Art
Thursday, November 10, 2016
www.krobarch.com

PAST WINNERS

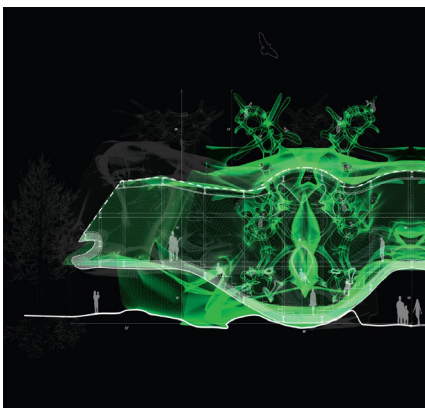
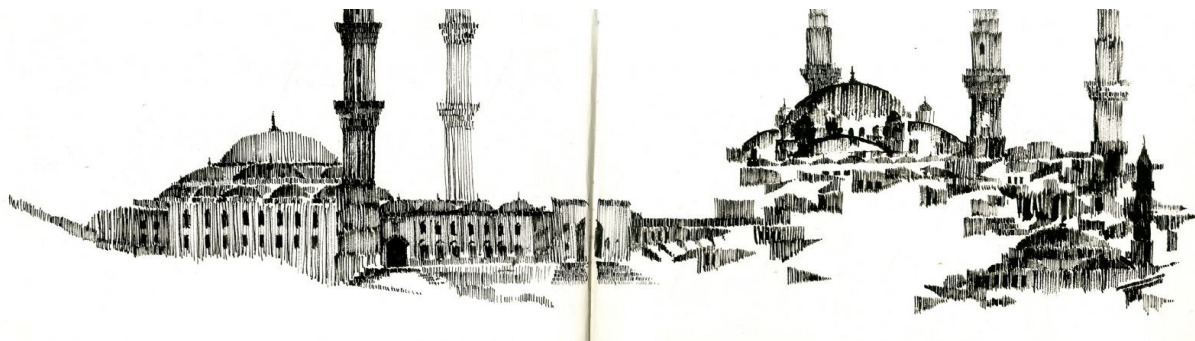
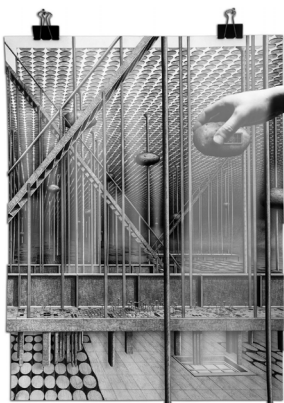
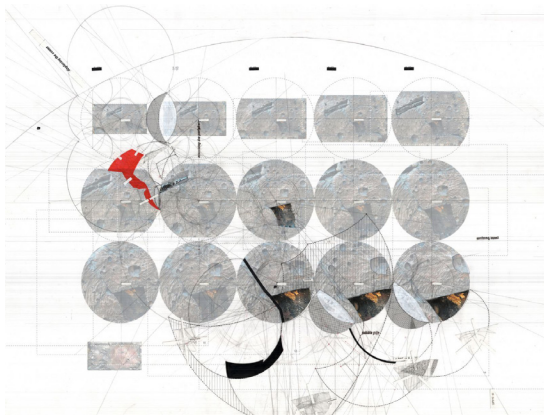
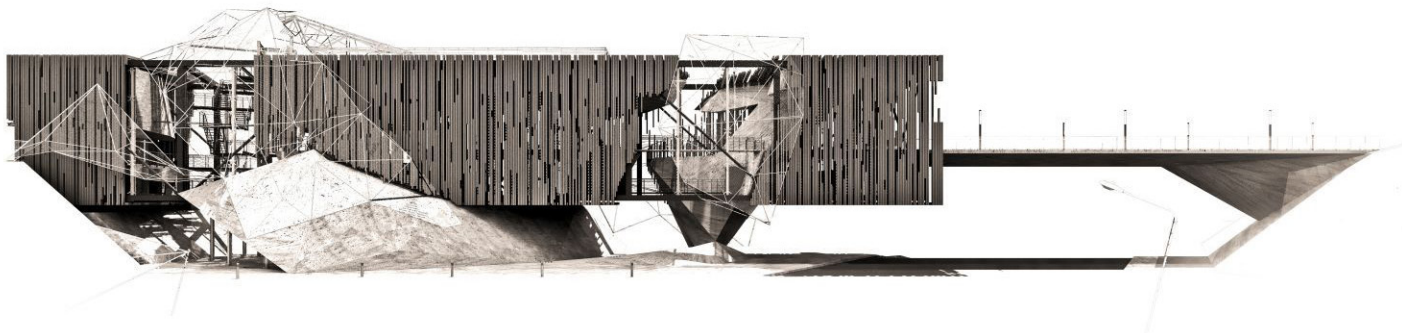

PAST WINNERS

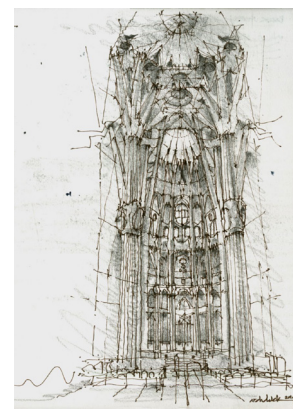
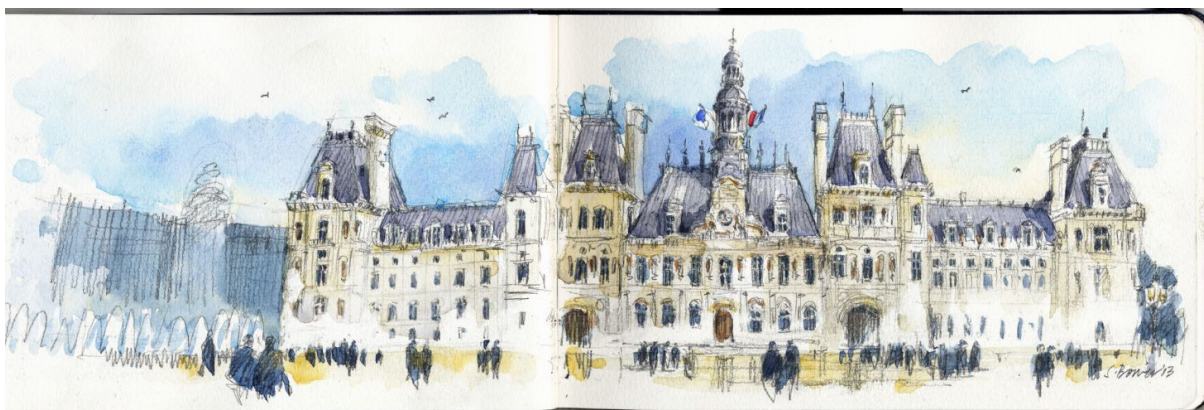
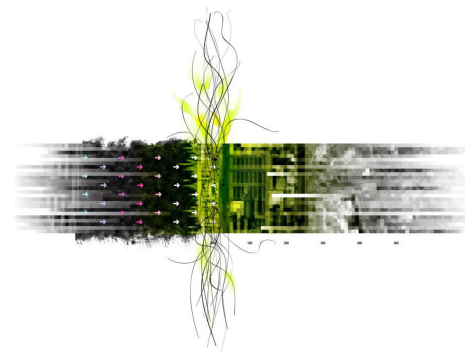
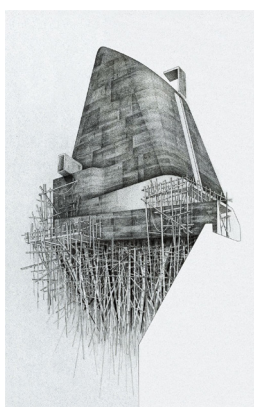
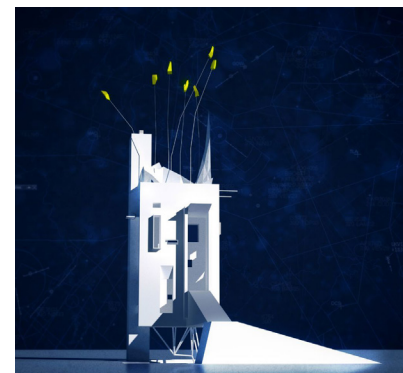
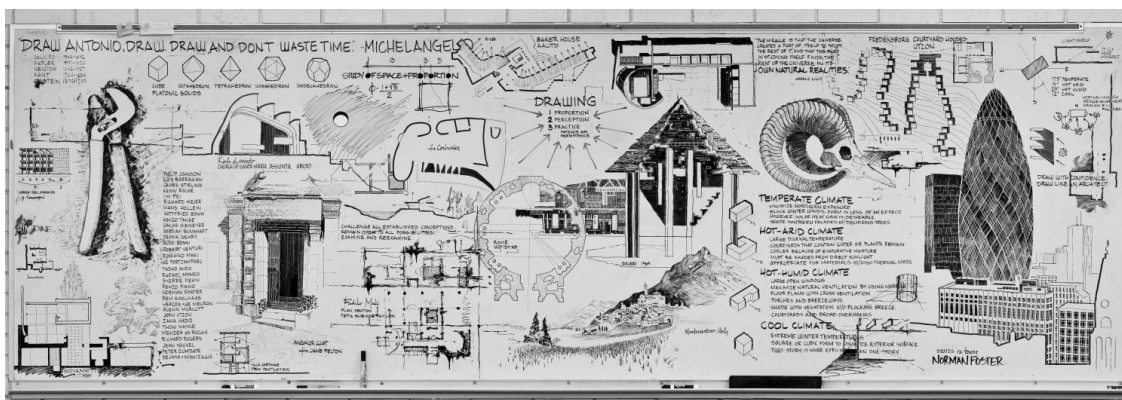
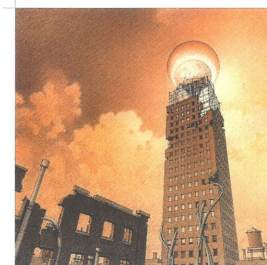
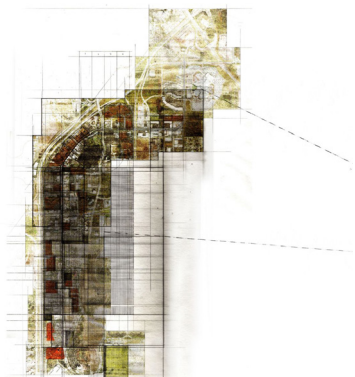

ABOUT THE KEN ROBERTS MEMORIAL DELINEATION COMPETITION

AIA Dallas's Ken Roberts Memorial Delineation Competition is the longest running architectural drawing competition in the world. Organized by the Dallas Chapter of the American Institute of Architects since 1974, the Ken Roberts Competition awards prizes to original works that best represent the artistic qualities of architecturally inspired drawings, produced by hand, digital CG or a combination of both. Entries are judged by a three member panel that have included nationally renowned architects, locally celebrated designers and editors for popular magazines. For most of its history, Krob was a local competition for architects and renderers in the Dallas/Fort Worth region. Since accepting drawings electronically for the past years, the competition has grown dramatically.

KROB HISTORY

In the late 1920's, The Architectural League of New York established the first American competition for architectural drawings. It was named after Birch Long, one of their greatly talented and much-loved members who died while working on their 1927 exhibition. The "Birch Burdette Long Memorial Prize" was awarded annually until 1972, when it was discontinued for lack of interest in architectural illustration.

It seems a remarkable coincidence, indeed that a new annual event in far-away Texas was initiated the following year by the Dallas Chapter of the AIA, and was subsequently named for the untimely death of a respected colleague.

This event preceded by two years the 1975 founding of the British Society of Architecture Illustrators (SAI), the first of several national organizations to follow. In 1980 the Japanese Architectural Renderers Association (JARA) was initiated, followed by the 1986 founding of The American Society of Architectural Perspectivists (ASAP) in Boston by Frank Constantino, Steve Rich and myself. The NYSR in New York and the short-lived New Jersey Association were formed soon after ASAP. After the Koreans founded KAPA in 1990, the Australians became the "newest kid on the block" with their AAI, which was organized [in 1995]. All this makes the Ken Roberts the most senior architectural drawing competition currently in operation anywhere in the world. - (article researched and written by Paul Stevenson Oles, FAIA)

WHO WAS KEN ROBERTS?



Ken Roberts was a Louisiana native and an architect who worked for the firm Craycroft-Lacy & Partners during the late 1960's in Dallas. He then left to join forces with Dick Savage and later with Clutts & Parker to form Iconoplex, Inc in 1973. As his former boss Jack Craycroft recalls, Roberts was "a great designer and even better architect". In addition, Roberts produced numerous immaculate ink perspective drawings of small residential and commercial projects that testified to an impressive facility for architectural rendering by hand. With the departure of his star employee, Craycroft felt a compelling need to show appreciation for skilled delineators. He thus came up with the idea of creating an annual delineation competition and exhibit during his tenure as president of AIA Dallas in 1973. The following year, AIA Dallas President Jim Clutts handed his colleague Ken Roberts the task of organizing the very first delineation event. Not long after the successful inaugural event, Roberts' chronic kidney problems suddenly ended his life at the age of 34. The AIA Dallas Executive Committee promptly renamed the annual delineation event after its first organizer, who was highly esteemed for the wide breadth of his abilities and admired for his enthusiasm and energy in the face of his declining health. - (article written by Julien Meyrat, AIA)

AWARDS

The Award for Excellence in Architectural 3D Printing | NEW |

This prize is awarded to the best student and professional entries that demonstrate excellence through the use of 3-D printing. Submissions must mainly focus on 3D printing as a way to convey architectural ideas. Models can range from concept models to section models and other architectural studies. To be considered for this prize, the entry must be submitted physically to the AIA Dallas office.

The Award for Excellence in Digital/Hybrid Media

This prize is awarded to the best student and professional entries that demonstrate excellence through an innovative use of media. Submissions may be digital, or hybrid mixed media with preference given to those that push the envelope of architectural representation.

The Award for Excellence in Hand Delineation

This prize is awarded to the best student and professional entries that embodies and celebrates the art of architecture as a tool for communication through hand delineations, sketches and renderings. Professional submissions should be the result of commissioned projects, while student entries need not be based in reality, but must be hand drawn for consideration in this category.

The Richard B. Ferrier Prize for Best Physical Delineation

In response to the large majority of entries being submitted electronically, this prize has been created to highlight and honor the unique properties inherent to physical drawings. KRob has traditionally been an event that honored physical submissions, and this prize is intended to maintain this practice. To be considered for this prize, the entry must be submitted physically to the AIA Dallas office.

The Kevin Sloan Prize for Best Travel Sketch

This award acknowledged individuals interested in the time honored activity of drawing architecture and places to learn and understand. In lieu of drawings made to "interpret" drawings submitted for this category are made to observe, analyze and record in a sketchbook.

Jurors Citation

These citations allow the jurors to independently select any student or professional piece that they personally wish to see recognized.

2016 JURORS



Dwayne Oyler

Dwayne Oyler received his Bachelor of Architecture from Kansas State University and Master of Architecture from Harvard University Graduate School of Design. He was awarded the Skidmore, Owings, and Merrill Traveling Fellowship in 1996. Prior to establishing Oyler Wu Collaborative, Dwayne worked for Toshiko Mori Architects and collaborated with Lebbeus Woods on numerous projects including Nine Boxes, Terrain, and Siteline Vienna. Dwayne has taught architecture studios at Syracuse University, The Research Institute for Experimental Architecture, and the Thesis Design Studio program at Cooper Union for the Advancement for Arts and Sciences in New York City. Dwayne currently teaches architecture design studios at the Southern California Institute of Architecture (SCLArc) and is also a visiting professor at Columbia GSAPP in New York. Dwayne Oyler and Jenny Wu of Oyler Wu Collaborative were honored by Harvard's Architectural League with an Emerging Voices Award.



Gabriel Esquivel

Gabriel Esquivel was born and educated as an architect in Mexico City with a degree from the National University and received his Master's Degree in Architecture from The Ohio State University. Gabriel Esquivel teaches architecture at the College of Architecture at Texas A&M University. He previously taught Architecture and Design at the Ohio State University. He is an invited professor at The Tecnológico of Monterrey in Mexico City.

His earlier professional experience comes from working in large corporate offices like NBBJ and completing projects in New York, Los Angeles, Santiago, Istanbul, Taipei, Beijing, Mexico City and Buenos Aires. The projects include healthcare, commercial, retail and residential developments.

Gabriel is promoter of new ideas in architecture, he has produced and organized conferences in Mexico City like Azul Rey, Elegantech, Ab Intra and Blurring Limits. He has recently organized a conference about Object Oriented Ontology.

After joining the architecture faculty at Texas A&M University, he has investigated the benefits and vehicles of a heterogeneous model that integrates both design technology and architecture's proprietary devices. Specifically, Gabriel Esquivel examines digital geometry and the emergence of new material logics. He also examines the integration of digital techniques and analogue conventions to exchange architectural information.

He has worked on different projects by himself and with collaborators, concentrating on developing a diversity of High Design projects, concentrating on the importance of a technological and theoretical apparatus. Gabriel just started a new office in Texas called "The Apparatus", he has worked on some projects like "La Riviera restaurant". Gabriel has a blog called "Theoremas" which is a forum for new ideas in architecture.

His research oscillates between fabrication techniques, performance and parametric investigations directly linked to the fabricated pieces, as well as the theoretical background behind these fabricated objects. These projects have been discussed on papers from SMI and Acadia from the parametric point of view as well as theory-based publications like Thresholds from MIT. He is the director of The T4T LAB at Texas A&M (Technology and Theory), the mission of the lab is to invite new young practitioners from all over the world to develop their ideas within a lab/studio format.

Gabriel has on-going collaboration with the Department of Aerospace Engineering at Texas A&M. This interdisciplinary focus is based on the idea of integrating SMA (shape memory alloys) to architectural surfaces, which means the possibility of moving specific parts of the surface with the purpose of controlling certain performances like light or ventilation. Consequently Gabriel Esquivel has taught several studios and workshops in the US, Mexico and South America that dealt with these issues providing the background for architecture education to be at the top of the cutting edge technology.



Gilbert Gorski

Gilbert Gorski, a licensed architect, is the designer for numerous projects, including the World Headquarters for the McDonald's Corporation in Oak Brook, Illinois and the Oceanarium, a major addition the John Shedd Aquarium in Chicago. He has also taught design studios and visualization techniques at the Illinois Institute of Technology, The School of the Art Institute in Chicago, and at the University of Notre Dame, where he held the James A. and Louise F. Nolen Chair in Architecture. In 1987 Mr. Gorski was designated the Burnham Fellow by the Chicago Architectural Club and was awarded a three-month fellowship to the American Academy in Rome. In 1990 and 2002, the American Society of Architectural Illustrators awarded Gorski the nation's highest singular honor in architectural illustration, the Hugh Ferriss Memorial Prize. He is author of Hybrid Drawing Techniques, Routledge Press 2015, and co-author of The Roman Forum, Cambridge University Press, 2015.

The past 2015 Jurors were Michel Rojkind, Paul Stevenson Oles, FAIA and John P. Maruszczak

WHY SPONSOR?

AIA Dallas's Ken Roberts Delineation Competition provides excellent marketing opportunities for those wishing to reach professionals in or related to the architectural industry around the world. Having received 391 entries from over 26 countries in the last year, KRob's visibility continues to grow, with its website receiving over 40,000 visitors each year since opening the competition internationally 6 years ago. Contest announcements and updates go directly to a mailing list of over 5,000 contacts. KRob has been published on over 50 competition websites and blogs and has received extensive coverage on Archinect.com, in Architect, Texas Architect and Columns magazines, among others. An exhibition of winning entries is displayed each year at the Dallas Center for Architecture and has traveled to other high profile venues, including AIA National and the Texas Society of Architects Annual Convention.

Sponsor benefits include:

- Extensive exposure to an interested, relevant and influential audience
- Corporate enhancement and brand recognition through the support of a non-profit organization dedicated to the architecture and design profession
- Opportunities to build your client base through unparalleled networking opportunities
- Promotion of your company's products and/or services
- Greater visibility and a way to differentiate your firm

As the competition continues to grow, it will increase the visibility of the companies that sponsor it. We look forward to your participation and support!

Warm Regards,

AIA Dallas

ABOUT AIA DALLAS

AIA Dallas, the seventh largest chapter of The American Institute of Architects, empowers architects to excel and impact their practice, profession and community. AIA Dallas has a membership base of more than 2,000 members and 300 architectural firms. More information about AIA Dallas can be found online at www.aiadallas.org.

KEN ROBERTS MEMORIAL DELINEATION COMPETITION SPONSORSHIP

KRob has celebrated the best in architectural delineation for 41 years. A Dallas classic that has received international recognition, KRob honors hand and digital delineation by professionals and students throughout the world. Since opening the competition internationally 6 years ago, Krob has received over 350 entries from 26 countries every year. The competition's visibility continues to grow with its website receiving over 40,000 visitors each year.

Expected outreach: 100,000+ member, general public, industry and industry affiliates, non-profits, government

PRESENTING PARTNER // ONE EXCLUSIVE OPPORTUNITY AVAILABLE

Event: Ken Roberts Memorial Delineation Competition

Expected exposure: World-Wide

\$10,000

- Naming rights to the competition, i.e. Your Company presents the AIA Dallas Ken Roberts Memorial Delineation Competition
- Formal acknowledgement and brief speaking opportunity at KRob event
- Sponsor logo on exhibition signage to be displayed at Dallas Center for Architecture & other high-traffic venues
- Complimentary Industry Allied membership or upgrade to Industry Allied Partner
- 10 tickets to KRob Awards Announcement
- Recognition on event signage and A/V presentation at event
- Sponsor logo on event print/online announcements & signage at event
- Sponsor logo on www.krobarch.com

AIA Dallas Presenting Partners receive special recognition and access to our members and resources.

- 3 ads in AIA Dallas weekly e-newsletter
- Brand identity placement in the reception area of the Dallas Center for Architecture
- Sponsor logo on major event print/online announcements & signage for our 6 major events *
- Invitation to attend major events
- One half-page advertisement in Columns magazine
- AIA Dallas Professional Affiliate membership

* Major events: Retropect, Golf Tournament, Design Awards, Ken Roberts Memorial Delineation Competition, Tour of Homes, Holiday Party

Platinum Sponsor \$3,500

Naming rights to one award: **Architectural 3D Printing, Digital/Hybrid Media, or Hand Delineation**

Complimentary Industry Allied membership or upgrade to Industry Allied Partner

Formal Acknowledgement and brief speaking opportunity at KRob event

Featured Press Opportunities

Sponsor logo on exhibition signage to be displayed at the Dallas Center for Architecture

Opportunity to place company material on combined sponsor table at the Conference

Six (6) tickets to KRob event

Recognition at the KRob event/plasmas

Sponsor logo on event print/on-line announcements & signage

Sponsor logo on KRobArch.com

Gold Sponsor \$2,000

Formal Acknowledgement and brief speaking opportunity at KRob event

Featured Press Opportunities

Sponsor logo on exhibition signage to be displayed at the Dallas Center for Architecture

Opportunity to place company material on combined sponsor table at the Conference

Four (4) tickets to KRob event

Recognition at the KRob event/plasmas

Sponsor logo on event print/on-line announcements & signage

Sponsor logo on KRobArch.com

Silver Sponsor \$1,000

Sponsor logo on exhibition signage to be displayed at the Dallas Center for Architecture

Opportunity to place company material on combined sponsor table at the Conference

Two (2) Tickets to KRob event

Recognition at the KRob event/plasmas

Sponsor logo on event print/on-line announcements & signage

Sponsor logo on KRobArch.com

Contributor Sponsor \$500

Ticket to KRob event

Recognition at the KRob event/plasmas

Sponsor name on event print/on-line announcements & signage

Sponsor logo on KRobArch.com

A WORLD WIDE AUDIENCE FOR YOUR SPONSORSHIP

2010-2014 Google Analytics for www.krobarch.com

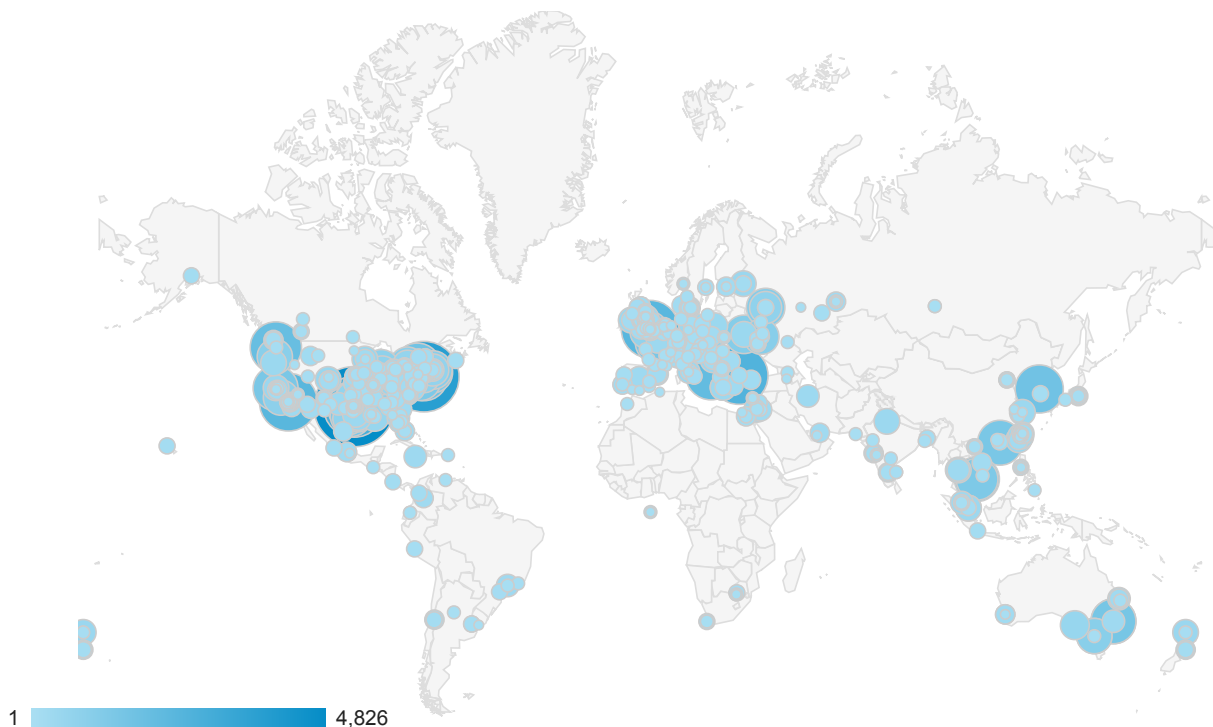

Country	Sessions	% New Sessions	New Users
180 Countries	197,745 % of Total:100.00%	59.56% Avg for View: 59.48%	117,780% of Total:100.15%
1. United States	81,800 (41.37%)	58.94%	48,214 (40.94%)
2. United Kingdom	14,181 (7.17%)	50.68%	7,187 (6.10%)
3. Australia	7,809 (3.95%)	63.06%	4,924 (4.18%)
4. Russia	5,843 (2.95%)	44.81%	2,618 (2.22%)
5. Canada	5,030 (2.54%)	65.17%	3,278 (2.78%)
6. Italy	4,071 (2.06%)	59.79%	2,434 (2.07%)
7. Turkey	3,820 (1.93%)	51.05%	1,950 (1.66%)
8. Ukraine	3,738 (1.89%)	25.58%	956 (0.81%)
9. Vietnam	3,730 (1.89%)	62.23%	2,321 (1.97%)
10. France	3,641 (1.84%)	61.08%	2,224 (1.89%)
11. Germany	3,544 (1.79%)	64.67%	2,292 (1.95%)
12. Taiwan	3,012 (1.52%)	58.40%	1,759 (1.49%)
13. Spain	2,950 (1.49%)	71.29%	2,103 (1.79%)
14. South Korea	2,716 (1.37%)	61.45%	1,669 (1.42%)
15. India	2,635 (1.33%)	80.95%	2,133 (1.81%)
16. Albania	2,413 (1.22%)	9.66%	233 (0.20%)
17. China	2,360 (1.19%)	73.43%	1,733 (1.47%)
18. Austria	1,889 (0.96%)	54.31%	1,026 (0.87%)
19. Mexico	1,842 (0.93%)	73.02%	1,345 (1.14%)
20. Brazil	1,834 (0.93%)	78.24%	1,435 (1.22%)

* Full Google Analytics report available upon request

Krob 2011-2014

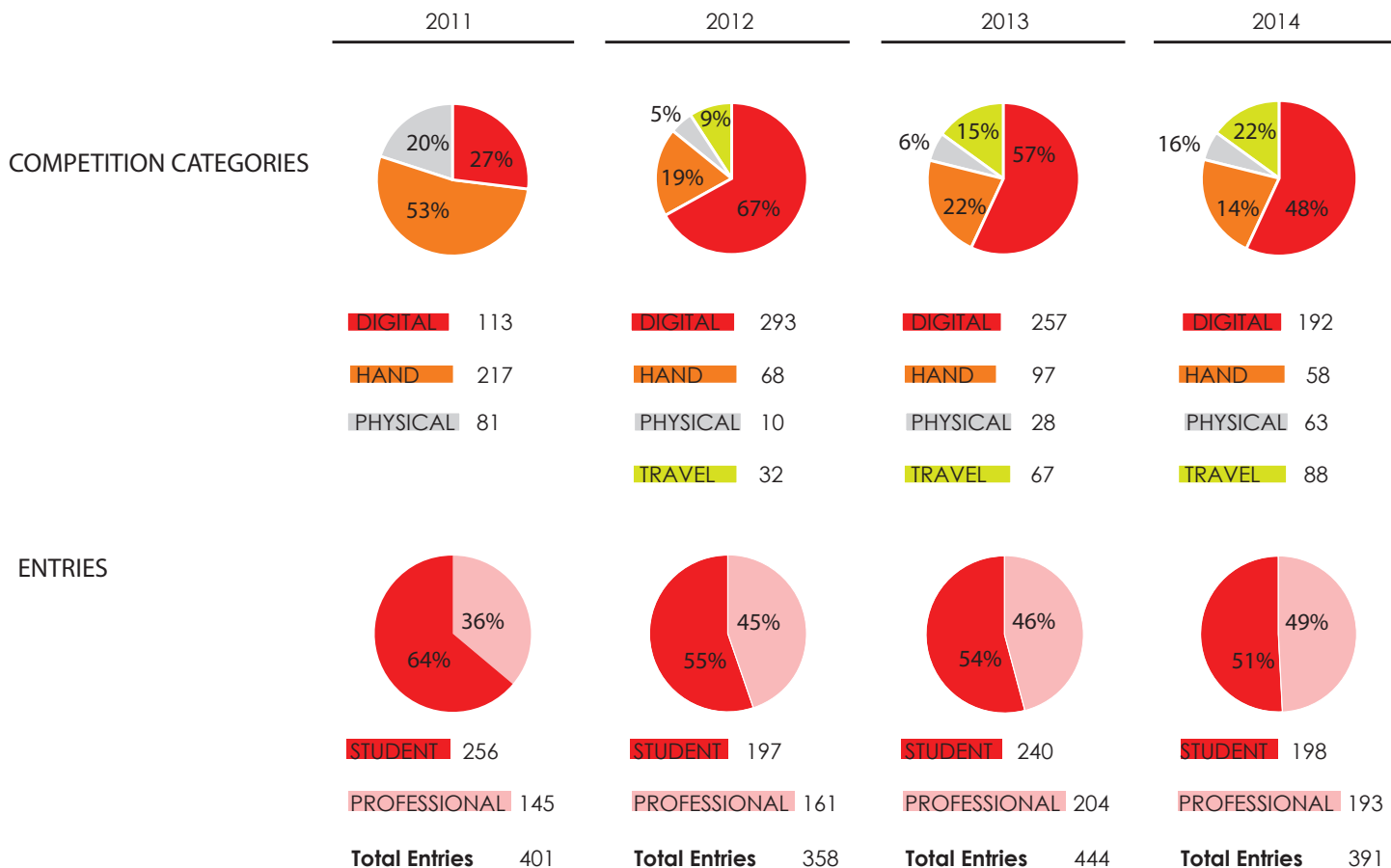

PAST Krob MEDIA COVERAGE

AIA DALLAS COLUMNS
 ARCHITECT MAGAZINE
 TEXAS ARCHITECT
 THE ARCHITECTURAL REVIEW ONLINE
 ARCHINECT
 BUSTLER
 ALEX HOGREFE
 WORLD ARCHITECTURE COMMUNITY
 WWW.DEXIGNER.COM
 TEXAS SOCIETY OF ARCHITECTS ANNUAL CONVENTION
 AIA NATIONAL
 EVOLO.US
 THE COMMERCIAL REAL ESTATE NETWORK
 AIA.ORG
 LIFE OF AN ARCHITECT.COM
 DEATH BY ARCHITECTURE.COM
 ARCHI.RU
 ALEXHOGREFE.SQUARESPACE.COM
 FACEBOOK.COM
 SCIARC.EDU
 LINKEDIN.COM
 PINTEREST.COM
 BING
 CGARCHITECT.COM

DRAWINGARCHITECTURE.TUMBLR.COM
 AKICHITLAS.COM
 CHOISHINE.COM
 FREISEBROTHERS.COM
 ARCHITECTUREANDMORALITY.BLOGSPOT.COM
 VKONTAKTE.RU
 VK.COM
 GOOGLE.CO.UK
 ARCHITECTUREANDDESIGN.COM.AU
 AIADALLAS.AFFINISCAPE.COM
 PLANANDSECTION.COM
 DESIGNCOMMUNICATIONASSOCIATION.ORG
 UNITEDLAB.ORG
 THEFOXISBLACK.COM
 AESTHETECHTONIK.COM
 BIOLINIA.COM
 T.CO
 FABRICIOMORA.TUMBLR.COM
 CONCURSOSARTE.COM
 SEMALT.SEMALT.COM
 ARCHIDOSE.BLOGSPOT.COM
 ARCHISKETCHBOOK.COM
 A~MAS.COM

ARCHITECTURELOVER.COM
 YANDEX
 AAAI.ORG.AU
 TALK.COLLEGECONFIDENTIAL.COM
 THEARCHITECTUREROOM.COM
 WWW4.UWM.EDU
 STUMBLEUPON.COM
 FORUMS.CGARCHITECT.COM
 MINISTRYOFTYPE.CO.UK
 YOURHOUSEDESIGN.COM
 E-ARCHITECT
 DETAILS D' ARCHITECTURE
 GIZMODO
 TUMBLR.COM
 EUROPA CONCORSI
 SCOUT MAGAZINE
 ELITE DAILY
 ARTHITECTURAL
 DETAIL
 INTERIOR DESIGN
 ARCH20
 123 INSPIRATION
 SOCIAL DESIGN MAGAZINE
 C | NET NEWS.COM

ARCHILOVERS
 WORLD ARCHITECTURE NEWS
 MAGZINE URUKIA
 DESIGN BOOM
 YAHOO
 DEZEEN MAGAZINE
 INHABITAT
 NEWS.COM.AU
 ARCHITIZER
 ARCHITECTURE LAB
 MARK
 ARCHITEXT
 CONCEPT
 MODULOR
 IGLOO
 POLIS
 WWW.NEXTTOPARCHITECTS.ORG
 SUCKERPUNCH
 ISSUU
 STEPHANIEBOWER.COM

FIRMS 2011-2015

3DARCHITECTURE PTY LTD
 5+DESIGN
 A4 STUDIO
 AA SCHOOL OF ARCHITECTURE
 ABEDIAN SCHOOL OF ARCHITECTURE, BOND UNIVERSITY
 AL MANAR UNIVERSITY OF TRIPOLI
 ALEX OTTICH ARCHITECTURAL ILLUSTRATOR
 ALISA DAWSON DESIGN
 ANDREW OSTERLUND ARCHITECT, PLLC
 ANDRITSOS ARCHITECT INT'L
 ANITA H. LEHMANN, ARCHITECT
 ANNA BOLDINA
 ARCHITECTURAL ACCENTS
 ARQUITECTONICAGEO
 ATELIER J-AR
 ATELIER8
 ATELIERJUN
 ATHFIELD ARCHITECTS LTD.
 BAR ARCHITECTS
 BAU EINS ARCHITEKTEN
 BECK
 BECKER MORGAN GROUP, INC.
 BILBEISI ARCHITECTS
 BLU HOMES, INC.
 BOHL ARCHITECTS
 BONHUI STUDIO
 BOOZIOTS & COMPANY
 BRG3S ARCHITECTS
 BRILLHART ARCHITECTURE
 BUCHANAN ARCHITECTURE
 BUENOS AIRES UNIVERSITY
 BYRENS KIM DESIGN WORKS/CAL POLY SAN LUIS OBISPO
 CALLISON
 CASEY BROWN ARCHITECTURE
 CBT ARCHITECTS
 CHOI+SHINE ARCHITECTS
 CITIZENSTUDIO
 CITY HOL OF TRSTENIK
 COMPANY KAPITELBUD
 CTA ARCHITECTS AND ENGINEERS
 CTA ENGINEERS AND ARCHITECTS
 CUMULOUS + MFA
 DALHOUSIE SCHOOL OF ARCHITECTURE
 DAYLUXE GALLERY
 DDG
 DESIGN UNDER SKY
 DESIGN WITH COMPANY
 DESIGNPED.COM
 DEVELOPMENT DESIGN GROUP
 DEWA DESIGN AND ILLUSTRATION
 DIOINNO ARCHITECTURE
 DOGKNOT STUDIO
 DOKC LAB
 DOTDWF DRAFTING & DESIGN
 EDWARD OGOSTA ARCHITECTURE
 EJES, INC.
 ELKUS MANFREDI ARCHITECTS
 ELNESS, SWENSON, GRAHAM
 ENSA PARIS VAL DE SEINE
 ENSAPVS
 ERNESTO LIEBRECHT ARCHITECT
 ESCUELA TÁCNICA SUPERIOR DE ARQUITECTURA DE MADRID
 ESCUELA TÁCNICA SUPERIOR DE ARQUITECTURA VALENCIA
 ESPAIMGR
 EXISTING CONDITIONS
 EXPERIMENTAL PROCESSES STUDIO
 EXPRESSPROJECT
 F.O.R.M.
 FAUP
 FISHER ARCHITECTURE LLC
 FKP ARCHITECTS
 FORREC LTD.
 FREECCELL ARCHITECTURE
 FREELANCE
 FREISEBROTHERS
 GARY SCHUBERTH AIA
 GENSLER
 GLAVE AND HOLMES ARCHITECTURE
 GMR MARKETING
 GOOD, FULTON & FARRELL
 GRAHAM THOMPSON
 GRAVEN IMAGES
 GREENWICH UNIVERSITY ENGLAND
 H2O ARCHITECTURAL DESIGN NETWORK
 HAMMERSLEY ARCHITECTURE
 HART HOWERTON
 HARTNESSVISION
 HERMAN WORKPLACE FOR ARCHITECTURE

HERON-MAZY
 HILDARODRIGUEZ ARCHITECTURE PLANNING INTERIORS LLC
 HKS INC.
 HNTB CORPORATION
 HOK
 HTWK LEIPZIG
 HUFF+GOODEN ARCHITECTS
 ILFI
 ILLUSTRATE MY DESIGN, LLC
 IMPRESSIVELY SIMPLE
 INSITE
 JACOBS ENGINEERING
 JAMES CHURCH & TOM REYNOLDS
 JASPER BROWN ARCHITECTS
 JAY CANTRELL DESIGN
 JCANTRELLDESIGN
 JCFO
 JHP ARCHITECTURE
 JNKA ARCHITECTS, LTD.
 JOFFREY MARQUIS ARCHITECT
 JOHNMATYAS ARCHITECTS
 JOSHUA J RIVERA ASSOCIATES
 JUSTER POPE FRAZIER ARCHITECTS
 KENDALL/HEATON ASSOCIATES
 KERNS GROUP ARCHITECTS
 KIL ARCHITECTURE + PLANNING
 KOH PEDERSEN FOX ARCHITECTS
 KOHLER COMPANY
 KOHN PEDERSEN FOX
 KOUZMANOFF BAINTON ARCHITECTS
 KPF
 KRECH, O'BRIEN, MUELLER & ASSOC.
 KRUECK + SEXTON ARCHITECTS
 L+A LANDSCAPE ARCHITECTURE
 LAGUARDALOW ARCHITECTS LLC.
 LARRY BOERDER ARCHITECTS
 LARSON & DARBY GROUP
 LEAN PRODUCTIONS
 LLC "KONSTRUKTIV"
 LONDON SOUTHBANK
 LUC HERBOTS
 LYNCH EISINGER DESIGN
 MACDOWELL.TOMOVA
 MAJ PLEMENITAS - LINKSCALE
 MAKEARCHITECTURE
 MAREK ARCHITECTURE
 MASS STUDIES
 MATRAKA LTDA
 MATT FAJKUS ARCHITECTURE
 MAXIMAL/JOSHUA MORATTO
 MAXWAN ARCHITECTS & URBANISTS
 MCBRIDE KELLEY BAURER, INC.
 MEIUS ARQUITETURA
 MERRIMAN ASSOCIATES ARCHITECTS
 METAMECHANICS
 MF ARCHITECTURE
 MICHAEL HARA DESIGN
 MITCHELL GIURGOLA ARCHITECTS
 MJ DESIGN
 MSR
 MUCHI EAST LLC
 MYRIAM MAHIQUES-LUIS MAKIANICH, CONSULTANT
 NIGEL GOUGH ILLUSTRATIONS
 NPS TCHOBAN VOSS
 OBJECTIVE AESTHETIC
 OCDC
 OEHME VAN SWEDEN
 OGLESBY GREENE ARCHITECTS
 OLSON KUNDIG ARCHITECTS
 ON42 ARCHITECTS
 PAGE
 PAUL STALLAN STUDIO _ RMJM
 PAYETTE ASSOCIATES
 PCPA
 PERKINS+WILL
 PETER HARTMAN
 PHINNEY DESIGN GROUP
 PIXELPOOL
 PLUSURBIA
 RAFA DESIGN
 REARDON SMITH
 RG_CC
 RINGMAN DESIGN + ILLUSTRATION
 RIPPLE DESIGN STUDIO
 ROBERT A.M. STERN ARCHITECTS
 RÖLLERHAUS PICTUREWORKS & DESIGN CO.
 RTKL ASSOCIATES INC.
 SEEMANN RUSH ARCHITECTS

SKIDMORE OWINGS AND MERRILL LLP
 SMMA
 SMVARCHITECTS
 SNARK DESIGN + NORTHERN ALBERTA INSTITUTE OF TECH
 SPAN ARCHITECTURE
 SPATIAL AFFAIRS BUREAU
 SFSU
 SRM ARCHITECTS
 STEINBOMER, BRAMWELL & VRAZEL ARCHITECTS
 STEPHANIE BOWER | ARCHITECTURAL ILLUSTRATION
 STEPHANIE BOWER, ARCHITECTURAL ILLUSTRATION
 STUDIO AK F.Z.E
 STUDIO VAIL LLC
 STUDIO:INDIGENOUS
 STUDIOS ARCHITECTURE
 STUDIO-SWAIM INC
 STUDIOJOA
 SUNÄ@HORN
 SWA GROUP
 TFP FARRELLS
 THE ARCHISTUDIO
 THE BECK GROUP
 THE CLARK ENERSEN PARTNERS
 THE SLAM COLLABORATIVE
 THE UNION OF ARCHITECTS OF RUSSIA
 THOMAS B LEYTHAM-ARCHITECT
 THOMSON & COOKE ARCHITECTS
 VIGILISM
 WATER+STRUCTURES
 WE-DESIGNS, LLC / HARVARD UNIVERSITY GSD
 WEINSTEIN FRIEDLEIN ARCHITECTS
 WHEAT ARCHITECTURE + DRAWING
 YELLOW WALL STUDIO
 ZGF ARCHITECTS
 ZIMMERMAN VISUAL

SCHOOLS 2011-2015

AA SCHOOL OF ARCHITECTURE
 AARHUS SCHOOL OF ARCHITECTURE
 ADITYA COLLEGE OF ARCHITECTURE
 ADJUNCT PROFESSOR-NORWICH UNIVERSITY
 ANITA LEHMANN
 ARCHITECTURAL ASSOCIATION SCHOOL OF ARCHITECTURE
 ARENA ANIMATION ACADEMY
 ARIEL UNIVERSITY SCHOOL OF ARCHITECTURE
 ARISTOTLE UNIVERSITY OF THESSALONIKI
 ARIZONA STATE UNIVERSITY
 AUBURN UNIVERSITY
 AUCKLAND UNIVERSITY
 BALL STATE UNIVERSITY
 BARTLETT SCHOOL OF ARCHITECTURE
 BAUHAUS-UNIVERSITÄT WEIMAR
 BERLAGE INSTITUTE
 BEUTH HOCHSCHULE FÜR TECHNIK BERLIN
 BIALYSTOK TECHNICAL UNIVERSITY
 BIOTECHNICAL FACULTY, UNIVERSITY OF LJUBLJANA
 BOSTON ARCHITECTURAL COLLEGE
 BRAC UNIVERSITY, DHAKA, BANGLADESH
 BRISTOL UNIVERSITY
 CAL POLY POMONA
 CALIFORNIA COLLEGE OF THE ARTS
 CALIFORNIA POLYTECHNIC UNIVERSITY, SAN LUIS OBISPO
 CARLETON UNIVERSITY, OTTAWA, CANADA
 CATHOLIC UNIVERSITY OF AMERICA
 CCAE
 CHIBA UNIVERSITY
 CHRISTCHURCH, NEW ZEALAND
 CHULALONGKORN UNIVERSITY
 CLEMSON UNIVERSITY
 COLUMBIA UNIVERSITY GSAPP
 COOPER UNION
 CORNELL UNIVERSITY
 CURTIN UNIVERSITY
 DALHOUSIE UNIVERSITY SCHOOL OF ARCHITECTURE
 DANIELS SCHOOL OF ARCHITECTURE
 DAYEH UNIVERSITY IN TAIWAN
 DEAKIN UNIVERSITY
 DEMONTFORT UNIVERSITY
 DRURY UNIVERSITY
 DUBLIN SCHOOL OF ARCHITECTURE, DIT
 ÉCOLE POLYTECHNIQUE FÉDÉRALE DE LAUSANNE
 EMILY CARR UNIVERSITY OF ART AND DESIGN
 ESALA, THE UNIVERSITY OF EDINBURGH
 FLORIDA A&M UNIVERSITY
 FLORIDA ATLANTIC UNIVERSITY
 GEORGIA INSTITUTE OF TECHNOLOGY
 GRADUATE SCHOOL OF HOSEI
 HARVARD UNIVERSITY GRADUATE SCHOOL OF DESIGN
 ILLINOIS INSTITUTE OF TECHNOLOGY
 INSTITUTO TECNOLÓGICO Y DE ESTUDIOS SUPERIORES DE MON-
 TERREY CAMPUS GUADALAJARA
 IOWA STATE UNIVERSITY
 IRAN UNIVERSITY OF SCIENCE AND TECHNOLOGY
 ISLAMIC AZAD UNIVERSITY OF SHIRAZ
 ISTANBUL TECHNICAL UNIVERSITY
 ITESM CAMPUS GUADALAJARA
 JACKSONVILLE UNIVERSITY
 JUDSON UNIVERSITY
 KANSAS STATE UNIVERSITY
 KENT STATE UNIVERSITY
 KOREA UNIVERSITY
 KYOTO UNIVERSITY, JAPAN
 LAKEVIEW CENTENNIAL HIGH SCHOOL
 LEICESTER SCHOOL OF ARCHITECTURE
 LEEDS METROPOLITAN UNIVERSITY
 LOUISIANA STATE UNIVERSITY
 LUND UNIVERSITY
 MANCHESTER SCHOOL OF ARCHITECTURE
 MARYWOOD UNIVERSITY
 MASSACHUSETTS INSTITUTE OF TECHNOLOGY
 MATT SWAIM
 MCGILL UNIVERSITY
 MIAMI DADE COLLEGE
 MOHOLY NAGY UNIVERSITY OF ART AND DESIGN
 MOME UNIVERSITY OF ART AND DESIGN
 MONTANA STATE UNIVERSITY
 MOSCOW ARCHITECTURAL INSTITUTE (STATE ACADEMY)
 NATIONAL CHENG KUNG UNIVERSITY, TAIWAN
 NATIONAL SCHOOL OF ARCHITECTURE, LYON FRANCE
 NATIONAL TECHNICAL UNIVERSITY OF ATHENS
 NEWCASTLE UNIVERSITY
 NORTH DAKOTA STATE UNIVERSITY
 NORWICH UNIVERSITY
 OCAD UNIVERSITY
 OKLAHOMA STATE UNIVERSITY

OXFORD BROOKES UNIVERSITY
 PARSONS THE NEW SCHOOL FOR DESIGN
 PENNSYLVANIA STATE UNIVERSITY
 POLITECNICO DI MILANO
 PONTIFICIA UNIVERSIDADE CATOLICA DO RIO DE JANEIRO
 PORTLAND STATE UNIVERSITY
 PRATT INSTITUTE
 PRINCE MOHAMMAD BIN FAHD UNIVERSITY
 PRINCETON UNIVERSITY SCHOOL OF ARCHITECTURE
 RHODE ISLAND SCHOOL OF DESIGN
 RICE UNIVERSITY
 RISD
 RMIT UNIVERSITY
 ROGER WILLIAMS UNIVERSITY
 ROYAL COLLEGE OF ART
 ROYAL MELBOURNE INSTITUTE OF TECHNOLOGY
 RUSSIAN ACADEMY OF PAINTING, SCULPTURE AND ARCHI
 RWTH AACHEN UNIVERSITY
 RYERSON UNIVERSITY
 SAVANNAH COLLEGE OF ART AND DESIGN
 SCI-ARC
 SHOWA WOMEN'S UNIVERSITY
 SINT LUCAS SCHOOL OF SCIENCE IN ARCHITECTURE
 SOUTHERN CALIFORNIA INSTITUTE OF ARCHITECTURE
 SUSHANT SCHOOL OF ART AND ARCHITECTURE
 SYRACUSE UNIVERSITY
 TAIWAN DAYEH UNIVERSITY
 TAUBMAN COLLEGE OF ARCHITECTURE AND URBAN PLANNING
 TEMPLE UNIVERSITY
 TEXAS A&M UNIVERSITY
 THE BARTLETT SCHOOL OF ARCHITECTURE
 THE OHIO STATE UNIVERSITY
 THE PENNSYLVANIA STATE UNIVERSITY
 THE RUSSIAN ACADEMY OF FINE ARTS
 THE UNIVERSITY OF ADELAIDE
 THE UNIVERSITY OF AUCKLAND
 THE UNIVERSITY OF HONG KONG
 THE UNIVERSITY OF MELBOURNE
 THE UNIVERSITY OF MICHIGAN TCAUP
 THE UNIVERSITY OF OKLAHOMA
 THE UNIVERSITY OF PENNSYLVANIA
 THE UNIVERSITY OF SYDNEY
 THE UNIVERSITY OF TEXAS AT ARLINGTON
 THE UNIVERSITY OF TEXAS AT AUSTIN
 THE UNIVERSITY OF TOKYO
 TIWAN DAYEH UNIVERSITY
 TOKYO INSTITUTE OF TECHNOLOGY
 TU DARMSTADT
 TU-KAISERSLAUTERN / GERMANY
 UC BERKLEY
 UCA CANTERBURY SCHOOL OF ARCHITECTURE
 UCLA
 UNC CHARLOTTE
 UNIVERSIDAD AUTONOMA DE NUEVO LEON
 UNIVERSIDAD CAMILO JOSÉ CELA, MADRID, SPAIN
 UNIVERSIDAD DE ALICANTE
 UNIVERSIDAD EUROPEA MIGUEL DE CERVANTES
 UNIVERSIDADE LUSÍADA PORTO
 UNIVERSITY AT BUFFALO
 UNIVERSITY COLLEGE LONDON, THE BARTLETT
 UNIVERSITY OF APPLIED ARTS VIENNA
 UNIVERSITY OF BRIGHTON
 UNIVERSITY OF BRITISH COLUMBIA
 UNIVERSITY OF BUENOS AIRES
 UNIVERSITY OF CALGARY
 UNIVERSITY OF CINCINNATI
 UNIVERSITY OF COLORADO - BOULDER
 UNIVERSITY OF COPENHAGEN
 UNIVERSITY OF EDINBURGH
 UNIVERSITY OF GEORGIA
 UNIVERSITY OF HONG KONG
 UNIVERSITY OF IDAHO
 UNIVERSITY OF ILLINOIS AT URBANA CHAMPAIGN
 UNIVERSITY OF INNSBRUCK
 UNIVERSITY OF KENT
 UNIVERSITY OF LIVERPOOL
 UNIVERSITY OF MANITOBA
 UNIVERSITY OF MANITOBA FACULTY OF ARCHITECTURE
 UNIVERSITY OF MELBOURNE
 UNIVERSITY OF MIAMI
 UNIVERSITY OF MIAMI SCHOOL OF ARCHITECTURE
 UNIVERSITY OF MICHIGAN
 UNIVERSITY OF MINNESOTA
 UNIVERSITY OF NATAL, SOUTH AFRICA
 UNIVERSITY OF NEBRASKA-LINCOLN
 UNIVERSITY OF NEVADA, LAS VEGAS
 UNIVERSITY OF NEW SOUTH WALES UNIVERSITY
 UNIVERSITY OF NOTRE DAME

UNIVERSITY OF NOTTINGHAM
 UNIVERSITY OF OKLAHOMA
 UNIVERSITY OF OREGON
 UNIVERSITY OF PENNSYLVANIA
 UNIVERSITY OF SCIENCES AND TECHNOLOGY OF ORAN
 UNIVERSITY OF SHEFFIELD
 UNIVERSITY OF SOUTH FLORIDA
 UNIVERSITY OF SOUTHERN CALIFORNIA
 UNIVERSITY OF TECHNOLOGY SYDNEY
 UNIVERSITY OF TEXAS AT SAN ANTONIO
 UNIVERSITY OF TORONTO
 UNIVERSITY OF VIRGINIA
 UNIVERSITY OF WATERLOO
 UNIVERSITY OF WATERLOO
 UNIVERSITY OF WESTMINSTER
 UNIVERSITY OF WISCONSIN-MILWAUKEE
 UNIVERSITY OF ZAGREB
 VFU CHERNORIZETS HRABAR
 VICTORIA UNIVERSITY OF WELLINGTON
 VIRGINIA COMMONWEALTH UNIVERSITY
 VIRGINIA POLYTECHNIC + STATE UNIVERSITY
 VIRGINIA TECH
 WALTER PARKS ARCHITECT
 WASHINGTON STATE UNIVERSITY
 WASHINGTON UNIVERSITY IN ST. LOUIS
 WEINSTEIN FRIEDLEIN ARCHITECTS
 WELSH SCHOOL OF ARCHITECTURE
 WENTWORTH INSTITUTE OF TECHNOLOGY
 WESTEAST DESIGN GROUP
 WILSON D DESIGN
 WOODBURY UNIVERSITY
 YALE SCHOOL OF ARCHITECTURE

26 COUNTRIES PARTICIPATED IN KRob2015



USA



ISRAEL



HUNGARY



VIETNAM

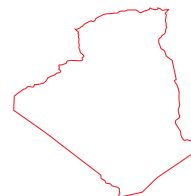

ALGERIA



POLAND



INDIA



ITALIA



RUSSIA



AUSTRALIA



FRANCE

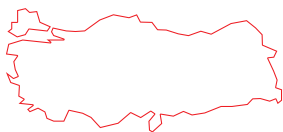

TURKEY



IRELAND



GREECE



THAILAND

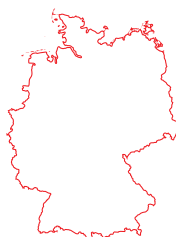

GERMANY



CANANDA



UK

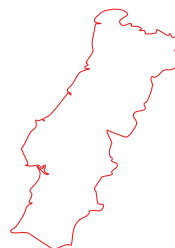

PORTUGAL



CROATIA



MEXICO



SINGAPORE



JAPAN



HONG KONG



TAIWAN



CHINA

